

LE MERIDIEN SEOUL

FROM SEPTEMBER 2017.
(PLEASE REFER TO HOTEL WEBSITE FOR ANY
CHANGES TO OPENING DATE.)

LE MERIDIEN SEOUL

120 Bongeunsa-ro,
Gangnam-gu, Seoul
06124, South Korea

Telephone:
+82-2-3451-8000
Facsimile:
+82-2-3451-8280

Email:
info@lemeridienseoul.com

www.lemeridienseoul.com

NEW HEIGHTS OF INSPIRATION

In the heart of Seoul's iconic Gangnam District, Le Méridien Seoul is an ideal base for discovering the local area's distinctive blend of the ancient, the cultured and the vibrant - where temples and malls, galleries and parks, sports and music, all provide a sensorial experience in a vibrant setting. Nearby attractions include Bongeunsa Temple, COEX Exhibition Center and Mall and Jamsil Baseball Stadium.

EXTRAORDINARY SERVICES

Located on the hotel's first floor, M Contemporary is an unprecedented cultural destination and recreational space in the heart of Gangnam. This art centre comprises seven exhibition venues throughout the hotel, including an LED media façade, a 1157-square-metre exhibition space, a private gallery for professional collectors, and a cafeteria that serves finger foods. On display are conventional paintings and sculptures as well as works by leading new media artists, revealing a fresh paradigm of public art and culture.

Socialize at Le Meridien Hub, our concept that re-interprets the hotel lobby into a social gathering space meant for you to convene and converse. Take advantage of our multi-compatible meeting spaces 1650 square metres intended to offer versatility to your corporate and social events. Dine leisurely at any of our four restaurants and bars or escape into the world of fiction at the Library Lounge while we spark creativity and adventure in your little ones at our Le Meridien Family Kids Club. For those who want to soak up the sun, we promise that the extensive outdoor pool and landscaped garden is nothing short of inviting.

STIMULATING GUESTROOMS

Experience our 336 stylish rooms and suites, decorated in a soothing palette of blue, lavender and green tones infused with European design flair. With local Gangnam area views and the exquisitely plush, signature Le Meridien bed, our spaces are curated to awaken the senses. For the ultimate in chic comfort, Le Meridien Club Lounge on the 14th floor offers exclusive benefits in sophisticated surroundings.

150	Le Méridien Classic
21	Balcony Deluxe
16	Family Deluxe
13	Le Méridien Club
89	Studio Suites
15	Junior Suites
3	Balcony Suites
27	Executive Suites
1	Royal Suite
1	Presidential Suite

INSPIRING CUISINE

Taste the unexpected and discover rare, culinary flavours and artful presentation in our restaurants and lounge bar.

Chef's Palette — For enjoyable terrace and buffet dining. Every morning, awaken to the great tastes of Le Méridien Signature Breakfast selection - traditional café classics enlivened with a modern twist.



BE EXPOSED TO THE UNCOMMON,
ENCOUNTER THE UNEXPECTED AND
IGNITE INSPIRATION.

DISCOVER A WORLD OF
POSSIBILITIES AND UNLOCK A
STIMULATING JUXTAPOSITION OF
UNIQUE KOREAN CULTURE, ART AND
INNOVATION, COMPLEMENTED BY
CHIC COMFORT AND GRACIOUS
HOSPITALITY AT LE MERIDIEN SEOUL.

N 37° 30' E 127° 01'
DESTINATION UNLOCKED

Le MERIDIEN

spg
Starwood
Preferred
Guest

©2017 Marriott International, Inc. All Rights Reserved.
Preferred Guest, SPG, Le Méridien and their logos are the
trademarks of Marriott International, Inc., or its affiliates.

Elements — Experience artistic contemporary Oriental cuisine by one of Korea's top chefs. Elements serves a diverse and modern Asian menu, encompassing Korean, Japanese, Chinese, Southeast Asian and halal dishes. The sushi counter offers a taste of authentic Japanese cuisine, while the barbecued Korean selection reveals a fresh and innovative global reinterpretation of Korean classics. Private dining rooms are available for exclusive gatherings.

Mid Century Bistro & Café — serves American-style bistro cuisine amid the 14-metre media wall of M Contemporary Art Centre and various other art works. A selection of snacks, sandwiches and main dishes at affordable prices.

Latitude 37 — With outstanding décor, this is a special venue to engage in relaxed conversation with friends and like-minded travelers over chilled wines, imaginative concoctions or the perfect illy specialty coffee, crafted by our skilled baristas.

Lab XXIV — a contemporary gastronomy-themed French restaurant, was featured in Michelin Guide 2017.

ENGAGING MEETING SPACE

Expand your vision beyond the usual. Inspire ideas and excite your creativity for the most desirable meetings and events. High Speed Internet Access is available throughout our meeting venues totaling 1,650 square metres. The outdoor Maple Garden is a forest garden lined with maple trees, producing an extraordinary location for private parties and unique weddings. A wide range of state-of-the-art audiovisual equipment and flexible services can be supplied by the hotel's expert in-house team.

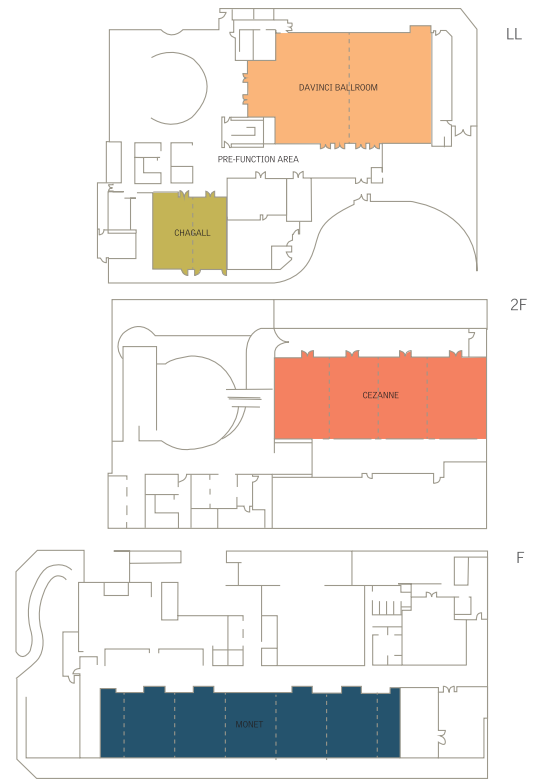

MEETING AMENITIES	Pyung	SqM	SqFt	Width M	Depth M	Height M	Banquet	Seminar	Theatre	U-Shape	Cocktail
DAVINCI BALLROOM 1	112	370	3983	21	16	6.5	250	210	400	60	300
DAVINCI BALLROOM 2	111	366	3939	21	16	6.5	250	210	400	60	300
DAVINCI BALLROOM (1+2)	223	736	7922	21	32	6.5	500	420	800	100	550
CHAGALL 1	31	103	1109	13.5	7.3	2.6	50	48	80	27	60
CHAGALL 2	31	103	1109	13.5	7.3	2.6	50	48	80	27	60
CHAGALL (1-2)	62	206	2218	13.5	14.6	2.6	100	99	160	*	110
CEZANNE 1	28.8	95	1023	11.3	7.5	2.8	50	48	80	27	60
CEZANNE 2	28.8	95	1023	11.3	7.5	2.8	50	48	80	27	60
CEZANNE 3	28.8	95	1023	11.3	7.5	2.8	50	48	80	27	60
CEZANNE 4	28.8	95	1023	11.3	7.5	2.8	50	48	80	27	60
CEZANNE (1-4)	115	380	4092	11.3	30	2.8	200	192	300	87	250
MONET 1	25	82	882.5	11	8	3.5	50	48	80	21	60
MONET 2	25	82	882.5	11	8	3.5	50	48	80	21	60
MONET 3	25	82	882.5	11	8	3.5	50	48	80	21	60
MONET 4	25	82	882.5	11	8	3.5	50	48	80	21	60
MONET (1-4)	100	328	3530	11	32	3.5	200	*	*	*	*
MAPLE GARDEN	159	525	5651	14	32	*	180	*	*	*	200
LE CIEL GARDEN	139	460	4946	11.6	30	*	100	*	*	*	130

SITUATED FOR DISCOVERY

- 01 COEX
- 02 Seolleung & Jeongneung
- 03 Jamsil Stadium
- 04 Namsan Seoul Tower

CONVENIENT ACCESS

We also offer easy access to both Incheon (ICN) and Gimpo (GMP) International Airports via the city's efficient rail network, located 65km and 30Km away, respectively.

